

MORSETTIERE CERTIFICATE UL/ CSA IN CLASSE TERMICA F

TERMINAL BLOCKS CERTIFIED UL/ CSA IN THERMAL CLASS F

CERTIFICATE OF COMPLIANCE

Certificate Number 20151124-E255714
Report Reference E255714-20051213
Issue Date 2015-NOVEMBER-24

Issued to: F I A M E SRL
VIA MONTE NERO 13 Z I
20010 BAREGGIO MI, ITALY

This is to certify that
representative samples of COMPONENT - TERMINAL BLOCKS
See Addendum Page.

Have been investigated by UL in accordance with the
Standard(s) indicated on this Certificate.

Standard(s) for Safety: UL 1059 & CAN/CSA C22.2 No. 158-10, Terminal Blocks.
Additional Information: See the UL Online Certifications Directory at
www.ul.com/database for additional information

Only those products bearing the UL Certification Mark should be considered as being covered by UL's
Certification and Follow-Up Service.

Recognized components are incomplete in certain constructional features or restricted in performance
capabilities and are intended for use as components of complete equipment submitted for investigation rather
than for direct separate installation in the field. The final acceptance of the component is dependent upon its
installation and use in complete equipment submitted to UL LLC.

Look for the UL Certification Mark on the product.

Bruce Mahrenhub, Director North American Certification Program
UL LLC

Any information and documentation involving UL Mark services are provided on behalf of UL LLC (UL) or any authorized licensee of UL. For questions, please
contact a local UL Customer Service Representative at info@ul.com or [1-800-368-6788](tel:18003686788)

Page 1 of 2

CERTIFICATE OF COMPLIANCE

Certificate Number 20151124-E255714
Report Reference E255714-20051213
Issue Date 2015-NOVEMBER-24

This is to certify that representative samples of the product as specified on this certificate were tested
according to the current UL requirements.

Component - Terminal Blocks.
Cat. No. 40x25, 54x34, 40x16, 32x32, 38x30, 50x40, 50x50, 40x40, followed by M4, may be followed by
"a" (for 50x40 M4 only), may be followed by " ", "b",
Cat. No. 64x40, 64x46, 82x45, 72x52, 74x38 followed by M5, may be followed by " ", "b",
Cat. No. 64x46 followed by M4, M5, may be followed by " ",
Cat. No. 65x65, 90x65, 82x52, 65x65, 90x65, followed by M6,
Cat. No. 82x52, followed by M6, M8,
Cat. No. 95x60, 115x70, followed by M8, M10,
Cat. No. 125x60, followed by M12,
Cat. No. 145x60 followed by M14,
Cat. No. 165x100 followed by M16,
Cat. No. 240x150 followed by M20
Cat No 44x27 followed by M4 followed by "D",
Cat No 50x32 followed by M4 followed by " ", "b" or "D",
Cat No 56x36 followed by M5 followed by " ", "b" or "D",
Cat No 70x45 followed by M6 followed by " " or "D",

Bruce Mahrenhub, Director North American Certification Program
UL LLC

Any information and documentation involving UL Mark services are provided on behalf of UL LLC (UL) or any authorized licensee of UL. For questions, please
contact a local UL Customer Service Representative at info@ul.com or [1-800-368-6788](tel:18003686788)

Page 2 of 2

Certificazione UL/CSA - UL/CSA Certification

CLASSI TERMICHE	PER ISOLAMENTO
CLASSE DI ISOLAMENTO	TEMPERATURA MASSIMA
Y	90 °C
A	105 °C
E	120 °C
B	130 °C
F	155 °C
H	180 °C
C	220 °C

SECONDO NORME C.E.I.

THERMAL CLASSES	
INSULATING CLASSES	MAXIMUM TEMPERATURE
Y	90 °C
A	105 °C
E	120 °C
B	130 °C
F	155 °C
H	180 °C
C	220 °C

ACCORDING TO STANDARDS C.E.I.

MORSETTIERE

TERMINAL BLOCKS



FIAME

OTTONE - BRASS

MORSETTIERE SERIE F.C. CERTIFICATE CLASSE TERMICA F (150 °C)

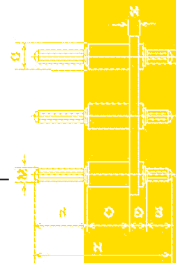

TERMINAL BLOCKS SERIES F.C. UL/CSA CERTIFIED THERMAL CLASS F (150°C)
con 6 perni fissi a base cilindrica - with 6 fixed base cylindrical studs

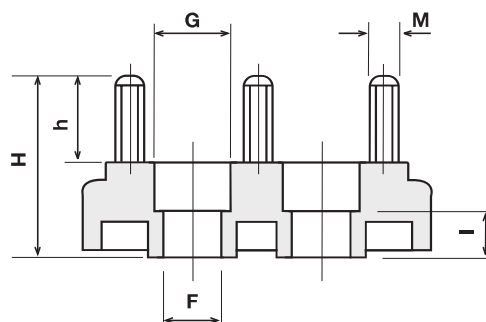
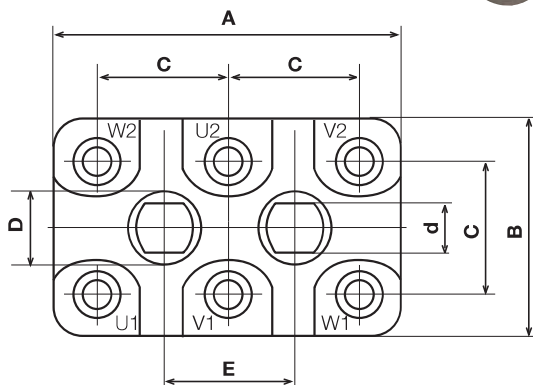

codice code	modello model	A	B	C	D	d	E	F	G	H	h	I	M
0116 MR	F.C. 40.25	40	25	15	9,3	5,1	15	7	9,3	21,5	12	5,5	M 4
0117 MR	F.C. 50.32	50	32	18	10,3	5,1	18	8,3	10,3	23	12	5	M 4
0118 MR	F.C. 56.36	56	36	20	12	6,2	20	9	12	26,5	15	6	M 5
0119 MR	F.C. 70.45	70	45	25	13,8	6,5	25	12	13,8	29	16	7,5	M 6
0120 MR	F.C. 82.52	82	52	30	14	6,5	30	10,5	14	32	16	12	M 6
0121 MR	F.C. 82.52	82	52	30	14	6,5	30	10,5	14	39,5	23	12	M 8
0122 MR	F.C. 95.60	95	60	35	16	8	35	12	19,8	46	23	14	M 8
0123 MR	F.C. 115.70	115	70	45	13,3	8,5	45	14,5	19,8	43	23	13	M 8
0124 MR	F.C. 95.60	95	60	35	13	8	35	11,8	15	48	28	9	M 10
0125 MR	F.C. 115.70	115	70	45	13,3	8,5	45	14,5	19,8	50	28	13,5	M 10
0126 MR	F.C. 125.80	125	80	45	16,5	11	45	16	21	58	32	15	M 12
0127 MR	F.C. 145.90	145	90	54	24	14	54	22	32	67	36	16	M 14
0128 MR	F.C. 165.100	165	100	62	23,5	13,5	63	24	30,5	78	40	26	M 16
0129 MR	F.C. 240.150	240	150	90	30	17	90	22	35	105	56	31	M 20

DOTAZIONE METALLICA STANDARD: 12 dadi, 3 piastrine, 6 rondelle
METALLIC STANDARD EQUIPMENT: 12 nuts, 3 links, 6 washers

Il corredo può essere composto in base alle esigenze del cliente e fornito, su specifica richiesta, in sacchetti singoli oppure in un'unica confezione.
The kit can be made according to customer needs and provided, on request, in individual sachets or in a single package.

OTTONE - BRASS

MORSETTIERE SERIE F.C. CERTIFICATE CLASSE TERMICA F (150 °C)



TERMINAL BLOCKS SERIES F.C. UL/CSA CERTIFIED THERMAL CLASS F (150°C)
con 6 perni fissi a base cilindrica - with 6 fixed base cylindrical studs

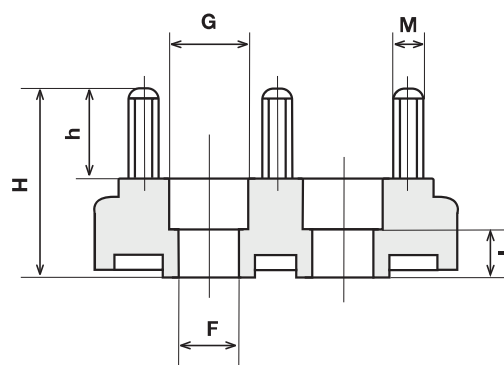
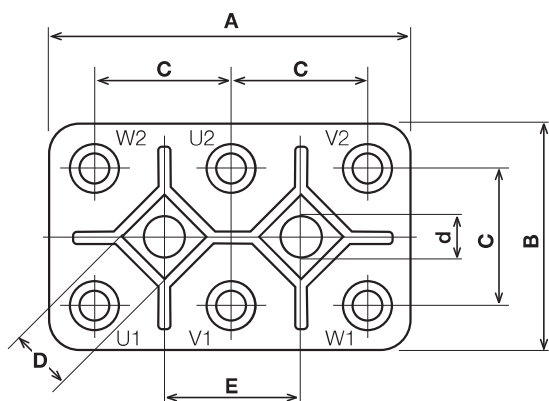

codice code	modello model	A	B	C	D	d	E	F	G	H	h	I	M
0131 MR	F.C. 54.34	54	34	20	10	6,2	20	6,2	14	25	12	6,5	M 4
0132 MR	F.C. 64.40	64	40	23	12	6,2	23	6,2	16	28	15	8	M 5

DOTAZIONE METALLICA STANDARD: 12 dadi, 3 piastrine, 6 rondelle
METALLIC STANDARD EQUIPMENT: 12 nuts, 3 links, 6 washers

Il corredo può essere composto in base alle esigenze del cliente e fornito, su specifica richiesta, in sacchetti singoli oppure in un'unica confezione.
The kit can be made according to customer needs and provided, on request, in individual sachets or in a single package.

OTTONE - BRASS

**MORSETTIERE SERIE F.C. CERTIFICATE
CLASSE TERMICA F (150 °C)**

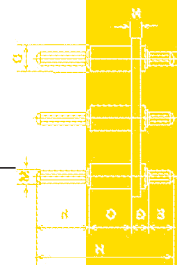

**TERMINAL BLOCKS SERIES F.C. UL/CSA CERTIFIED THERMAL CLASS F (150°C)
con 8 perni fissi a base cilindrica - with 8 fixed base cylindrical studs**

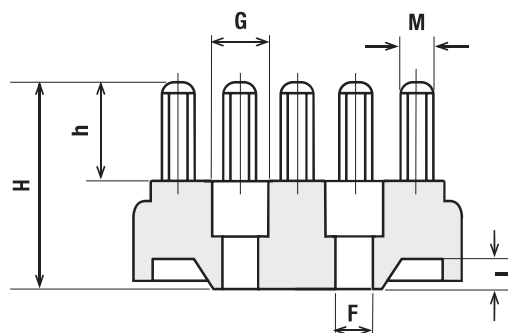
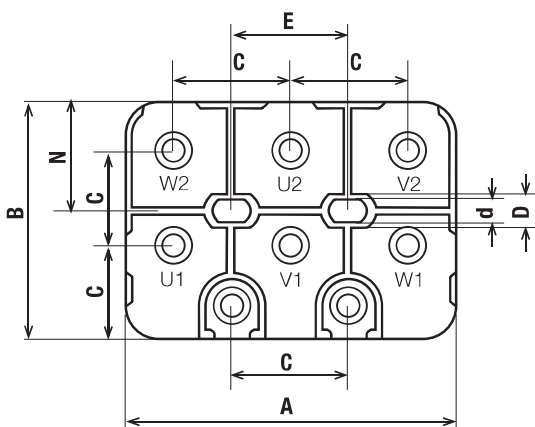

codice code	modello model	A	B	C	c	D	d	E	F	G	H	h	I	M	N
0192 MR	F.C. 50.40	50	40	18	15	8	4,7	18	6,8	9,8	26	12	6	M 4	18

DOTAZIONE METALLICA STANDARD: 14 dadi, 3 piastrine, 8 rondelle
METALLIC STANDARD EQUIPMENT: 14 nuts, 3 links, 8 washers

Il corredo può essere composto in base alle esigenze del cliente e fornito, su specifica richiesta, in sacchetti singoli oppure in un'unica confezione.
The kit can be made according to customer needs and provided, on request, in individual sachets or in a single package.

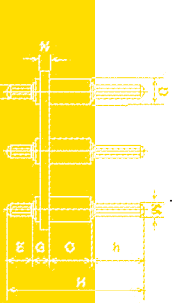

OTTONE - BRASS

**MORSETTIERE SERIE F.C. CERTIFICATE
CLASSE TERMICA F (150 °C)**



**TERMINAL BLOCKS SERIES F.C. UL/CSA CERTIFIED THERMAL CLASS F (150°C)
con 9 perni fissi a base cilindrica - with 9 fixed base cylindrical studs**

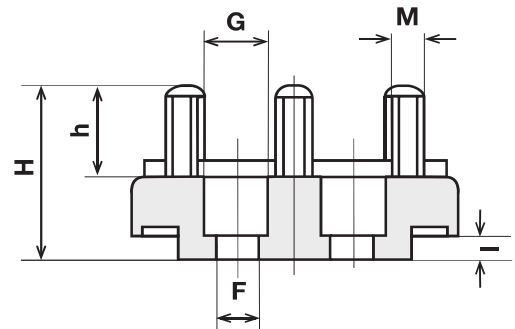
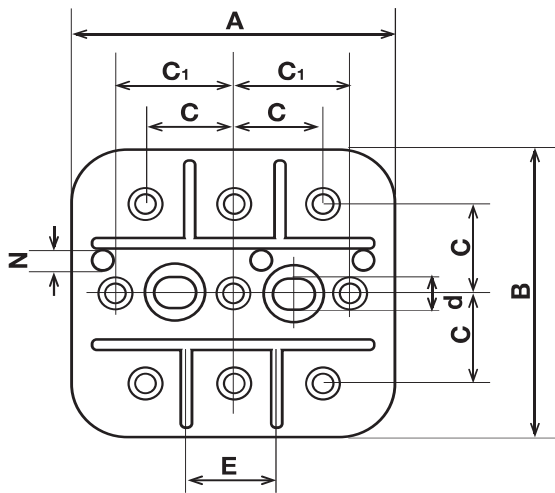

codice code	modello model	A	B	C1	C	d	E	F	G	H	h	I	M	N
0195 MR	F.C. 50.40	50	40	16	14	5,2	15	7	9	24	12	3,5	M 4	4
0196 MR	F.C. 62.45	62	45	20	15	6,5	20	8,5	10	29	14	5	M 5	4

DOTAZIONE METALLICA STANDARD: 18 dadi, 3 piastrine, 9 rondelle
METALLIC STANDARD EQUIPMENT: 18 nuts, 3 links, 9 washers

Il corredo può essere composto in base alle esigenze del cliente e fornito, su specifica richiesta, in sacchetti singoli oppure in un'unica confezione.
The kit can be made according to customer needs and provided, on request, in individual sachets or in a single package.

OTTONE - BRASS

MORSETTIERE SERIE F.C. CERTIFICATE CLASSE TERMICA F (150 °C)

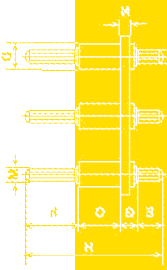

TERMINAL BLOCKS SERIES F.C. UL/CSA CERTIFIED THERMAL CLASS F (150°C)
con 9 perni fissi a base cilindrica - with 9 fixed base cylindrical studs

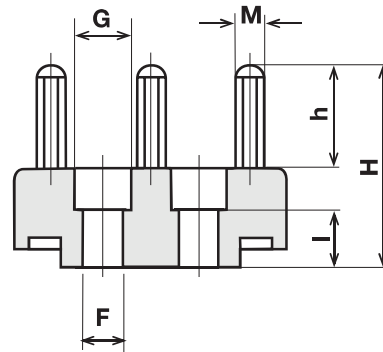
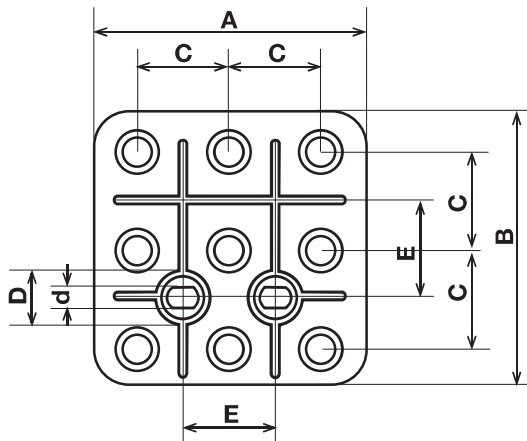

codice code	modello model	A	B	C	D	d	E	F	G	H	h	I	M
0197 MR	F.C. 40.40	40	40	15	8	4,7	15	6	8	22	12	7	M 4

DOTAZIONE METALLICA STANDARD: 18 dadi, 3 piastrine, 9 rondelle
METALLIC STANDARD EQUIPMENT: 18 nuts, 3 links, 9 washers

Il corredo può essere composto in base alle esigenze del cliente e fornito, su specifica richiesta, in sacchetti singoli oppure in un'unica confezione.
The kit can be made according to customer needs and provided, on request, in individual sachets or in a single package.

OTTONE - BRASS

MORSETTIERE SERIE F.C. CERTIFICATE CLASSE TERMICA F (150 °C)



TERMINAL BLOCKS SERIES F.C. UL/CSA CERTIFIED THERMAL CLASS F (150°C)
con 9 perni fissi a base cilindrica - with 9 fixed base cylindrical studs

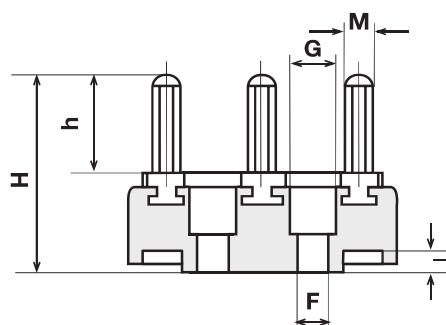
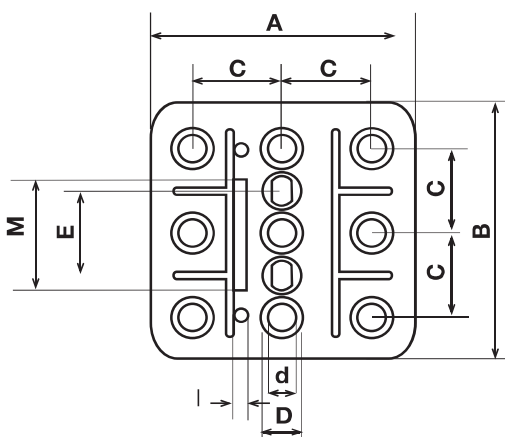

codice code	modello model	A	B	C	D	d	E	F	G	H	h	I	M	N
0201 MR	F.C. 50.50	50	50	18	9	5,2	18	7,5	9	24	4,5	23	M 4	4,5

DOTAZIONE METALLICA STANDARD: 18 dadi, 3 piastrelle, 9 rondelle
METALLIC STANDARD EQUIPMENT: 18 nuts, 3 links, 9 washers

Il corredo può essere composto in base alle esigenze del cliente e fornito, su specifica richiesta, in sacchetti singoli oppure in un'unica confezione.
The kit can be made according to customer needs and provided, on request, in individual sachets or in a single package.

OTTONE - BRASS

MORSETTIERE SERIE F.C. CERTIFICATE US CLASSE TERMICA F (150 °C)

TERMINAL BLOCKS SERIES F.C. UL/CSA CERTIFIED THERMAL CLASS F (150°C)
con 9 perni fissi a base cilindrica - with 9 fixed base cylindrical studs

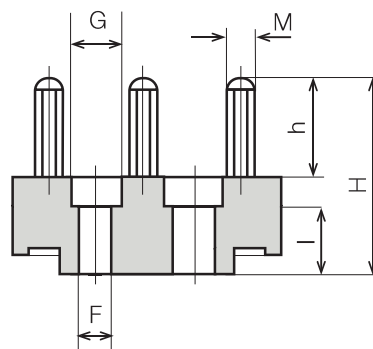
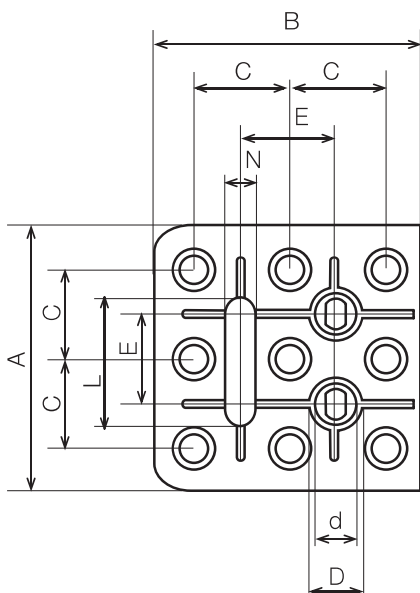
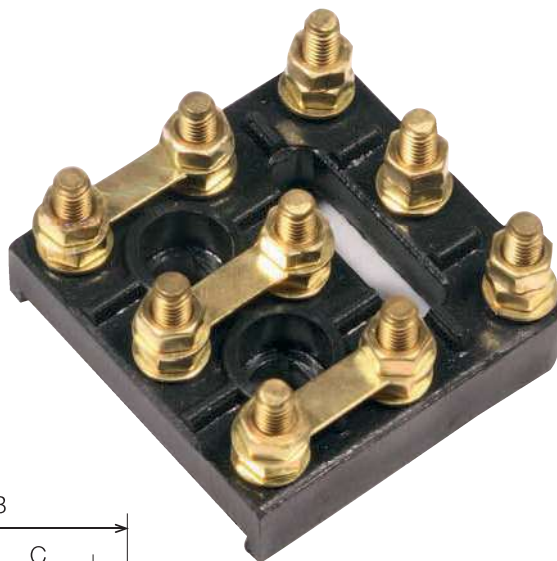
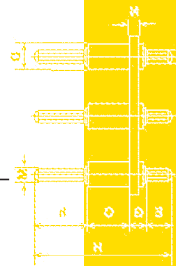

codice code	modello model	A	B	C	D	d	E	F	G	H	h	I	L	M	N
0204 MR	F.C. 52.52	52	52	20	11,7	6,7	20	8,5	11,7	28	15	7	30	M 5	7,5
0205 MR	F.C. 65.65	65	65	25	13,8	6,7	25	11	13,8	32	16	10,5	35	M 6	10,3

DOTAZIONE METALLICA STANDARD: 18 dadi, 3 piastrine, 9 rondelle
METALLIC STANDARD EQUIPMENT: 18 nuts, 3 links, 9 washers

Il corredo può essere composto in base alle esigenze del cliente e fornito, su specifica richiesta, in sacchetti singoli oppure in un'unica confezione.
The kit can be made according to customer needs and provided, on request, in individual sachets or in a single package.

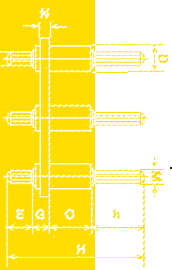

OTTONE - BRASS

**MORSETTIERE SERIE F.C. CERTIFICATE
CLASSE TERMICA F (150 °C)**



**TERMINAL BLOCKS SERIES F.C. UL/CSA CERTIFIED THERMAL CLASS F (150°C)
con 12 perni fissi a base cilindrica - with 12 fixed base cylindrical studs**

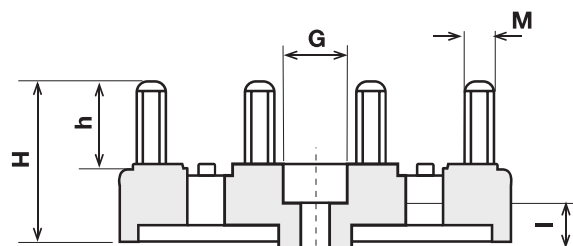
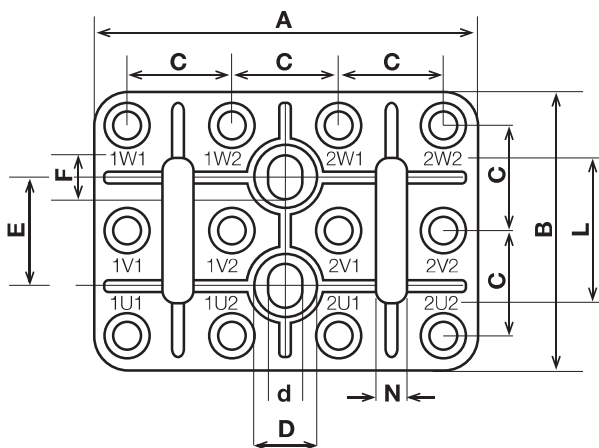

codice code	modello model	A	B	C	D	d	E	F	G	H	h	I	L	M	N
0211 MR	F.C. 64.46	64	46	18	10	5,5	18	8	10	23	12	5	25	M 4	6,5
0212 MR	F.C. 72.52	72	52	20	11,5	6,5	20	8,5	11,5	28	15	7	30	M 5	7,5
0213 MR	F.C. 90.65	90	65	25	13,8	6,5	25	11	13,8	32	16	10	35	M 6	10,3

DOTAZIONE METALLICA STANDARD: 24 dadi, 6 piastrine, 12 rondelle
METALLIC STANDARD EQUIPMENT: 24 nuts, 6 links, 12 washers

Il corredo può essere composto in base alle esigenze del cliente e fornito, su specifica richiesta, in sacchetti singoli oppure in un'unica confezione.
The kit can be made according to customer needs and provided, on request, in individual sachets or in a single package.

MORSETTIERE SERIE F.C. CERTIFICATE  US
CLASSE TERMICA F (150 °C)

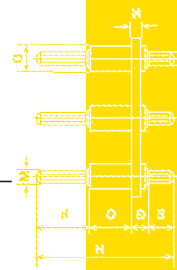

TERMINAL BLOCKS SERIES F.C. UL/CSA CERTIFIED THERMAL CLASS F (150°C)
con 2 perni fissi a base cilindrica - with 2 fixed base cylindrical studs

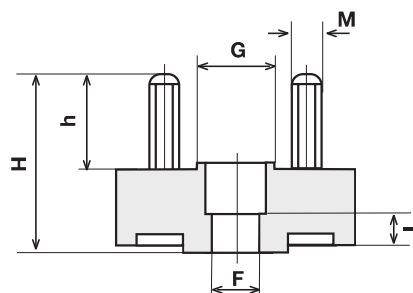
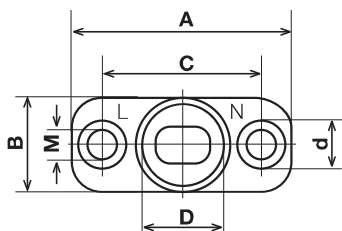
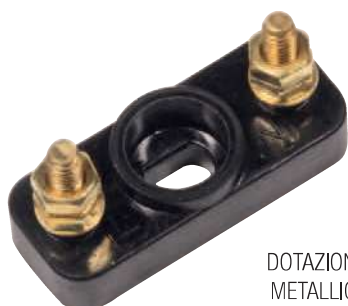

DOTAZIONE METALLICA STANDARD: 4 dadi, 2 rondelle
METALLIC STANDARD EQUIPMENT: 4 nuts, 2 washers

codice code	modello model	A	B	C	D	d	F	G	H	h	I	M
0189 MR	F.C. 40.16	40	16	29	11,8	5	8	15,3	23	12	5	M 4

con 4 perni fissi a base cilindrica - with 4 fixed base cylindrical studs

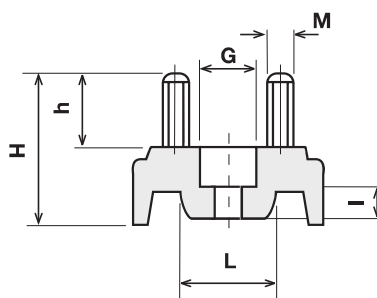
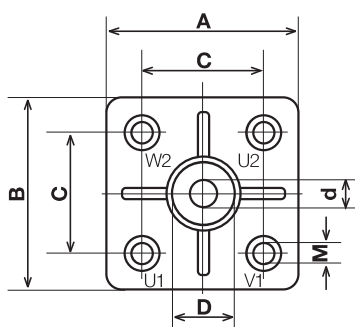

DOTAZIONE METALLICA STANDARD: 8 dadi, 2 piastrine, 4 rondelle
METALLIC STANDARD EQUIPMENT: 8 nuts, 2 links, 4 washers

codice code	modello model	A	B	C	D	d	G	H	h	I	L	M
0190 MR	F.C. 32.32	32	32	18	9,8	4,3	13	25	12	7,5	15	M 4

con 4 perni fissi a base cilindrica - with 4 fixed base cylindrical studs

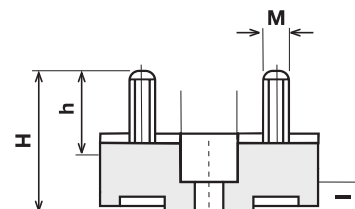
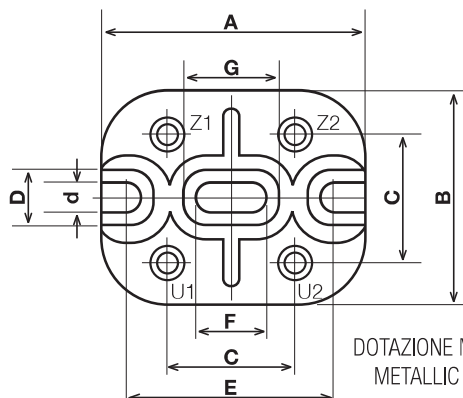

DOTAZIONE METALLICA STANDARD: 8 dadi, 2 piastrine, 4 rondelle
METALLIC STANDARD EQUIPMENT: 8 nuts, 2 links, 4 washers

codice code	modello model	A	B	C	D	d	E	F	G	H	h	I	M
0191 MR	F.C. 38.30	38	30	18	8,2	5	24	10,3	14	21	12	4	M 4

Il corredo può essere composto in base alle esigenze del cliente e fornito, su specifica richiesta, in sacchetti singoli oppure in un'unica confezione.
The kit can be made according to customer needs and provided, on request, in individual sachets or in a single package.

OTTONE - BRASS

**MORSETTIERE SERIE F.C. CERTIFICATE
CLASSE TERMICA F (150 °C)**



TERMINAL BLOCKS SERIES F.C. UL/CSA CERTIFIED THERMAL CLASS F (150°C)
con 9 perni fissi a base cilindrica - with 9 fixed base cylindrical studs

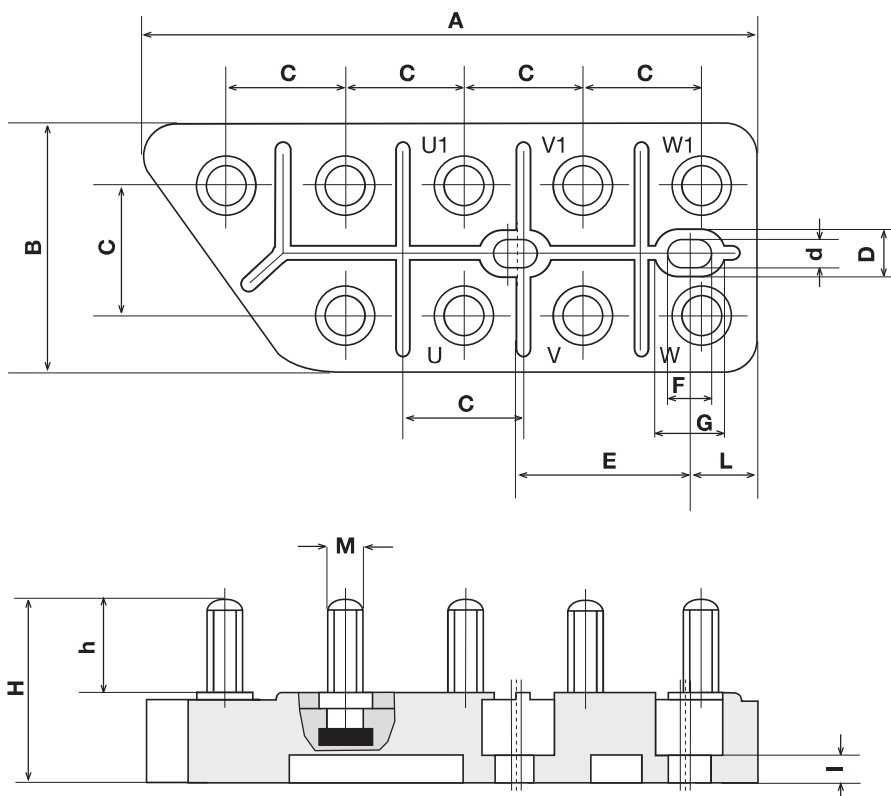

codice code	modello model	A	B	C	D	d	E	F	G	H	h	I	L	M
0207 MR	F.C. 134.50	134	50	28	11,6	7,4	40	11,1	15	47,5	23	9,5	14	M 8

DOTAZIONE METALLICA STANDARD: 18 dadi, 4 piastrine, 9 rondelle
METALLIC STANDARD EQUIPMENT: 18 nuts, 4 links, 9 washers

Il corredo può essere composto in base alle esigenze del cliente e fornito, su specifica richiesta, in sacchetti singoli oppure in un'unica confezione.
The kit can be made according to customer needs and provided, on request, in individual sachets or in a single package.

OTTONE - BRASS

MORSETTIERE SERIE F.C. CERTIFICATE CLASSE TERMICA F (150 °C)

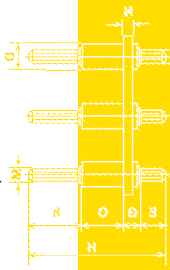

TERMINAL BLOCKS SERIES F.C. UL/CSA CERTIFIED THERMAL CLASS F (150°C)
con 8 perni fissi a base cilindrica - with 8 fixed base cylindrical studs

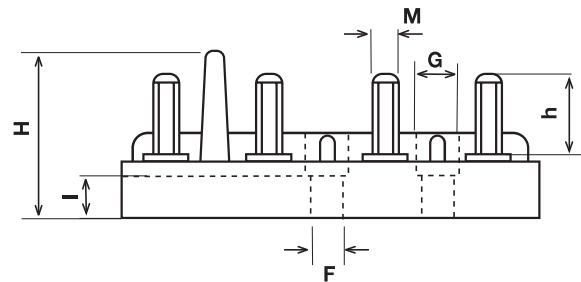
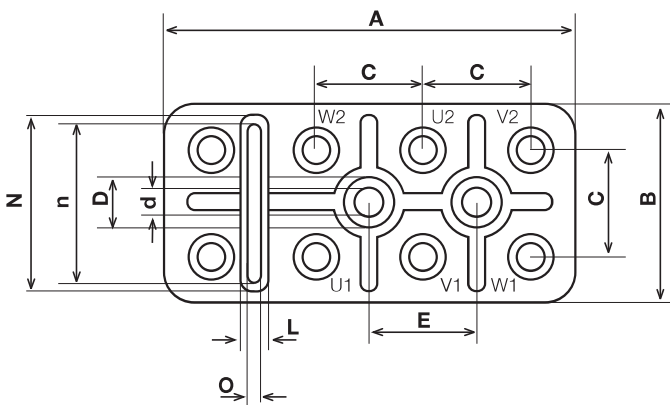

codice code	modello model	A	B	C	D	d	E	F	G	H	h	I	L	M	N	n	O
0216 MR	F.C. 74.36	74	36	20	11	6,7	20	10,8	11	30	15	7	5	M 5	32	30	3

DOTAZIONE METALLICA STANDARD: 14 dadi, 3 piastrine, 8 rondelle
METALLIC STANDARD EQUIPMENT: 14 nuts, 3 links, 8 washers

Il corredo può essere composto in base alle esigenze del cliente e fornito, su specifica richiesta, in sacchetti singoli oppure in un'unica confezione.
The kit can be made according to customer needs and provided, on request, in individual sachets or in a single package.

OTTONE - BRASS

MORSETTIERE SERIE F.Q. (BASE QUADRA)
CERTIFICATE  US CLASSE TERMICA F (150 °C)

TERMINAL BLOCKS SERIES F.Q. (SQUARE BASE) UL/CSA CERTIFIED THERMAL CLASS F (150°C)
6 perni fissi a base quadra - 6 fixed base square studs

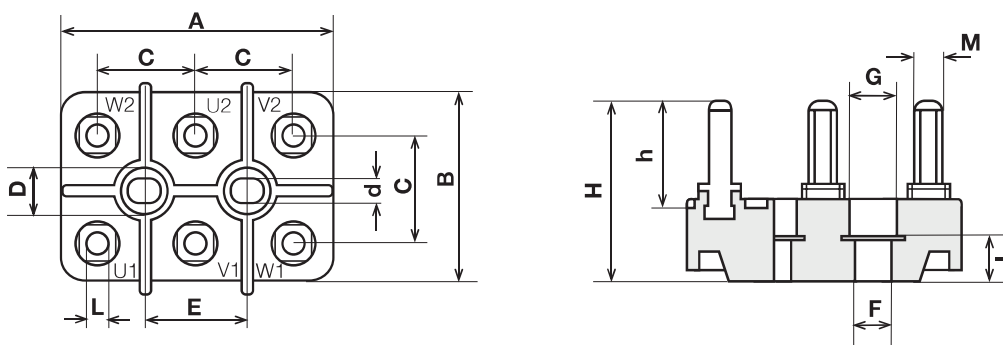

codice code	modello model	A	B	C	D	d	E	F	G	H	h	I	L	M
0142 MR	F.Q. 64,46	64	46	23	10,2	5,0	23	5	10,2	35	12	8	10	M 5

caratteristiche
specifications

isolante insulating

Melopas MP 183

elementi di connessione
elements of connection

antiscintillio
antisparking

DOTAZIONE METALLICA STANDARD: 6 dadi, 3 piastrine, 6 rondelle grower, 6 serrafili, 6 capicorda preisolati.
METALLIC STANDARD EQUIPMENT: 6 nuts, 3 links, 6 grower washers, 6 clamping screws, 6 ring terminals.

Il corredo può essere composto in base alle esigenze del cliente e fornito, su specifica richiesta, in sacchetti singoli oppure in un'unica confezione.
The kit can be made according to customer needs and provided, on request, in individual sachets or in a single package.

MORSETTIERE SERIE A.D. ANTIDEFLEGRANTI
CLASSE TERMICA F (150 °C)

TERMINAL BLOCKS SERIES A.D. EXPLOSION-PROOF THERMAL CLASS F (150°C)

6 perni fissi doppia filettatura a base cilindrica
6 fixed double screw thread base cylindrical studs

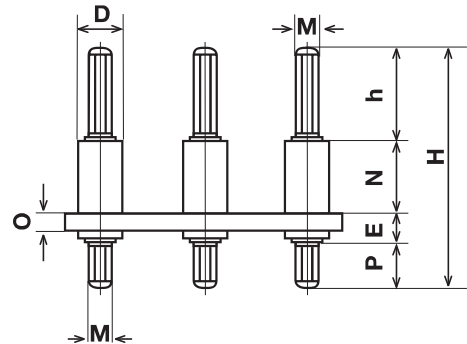
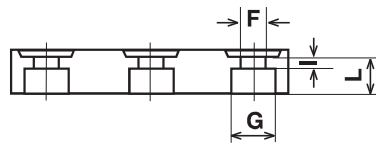
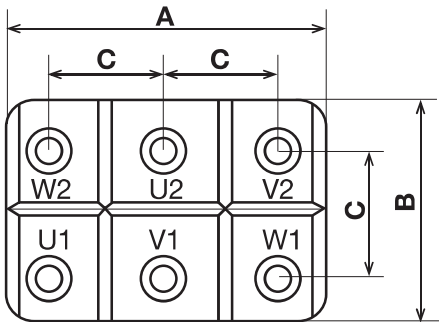
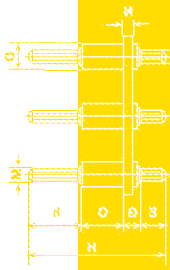

codice code	modello model	A	B	C	D	E	F	G	H	h	I	L	M	N	O	P
0182 MR	A.D. 50.32	50	32	16	9,8	12,7	6,3	10	58	18	4	5	M 5	16	6,2	10

DOTAZIONE METALLICA STANDARD: 18 dadi, 3 piastrine, 12 rondelle, 6 rondelle grower
METALLIC STANDARD EQUIPMENT: 18 nuts, 3 links, 12 washers, 6 grower washers

Il corredo può essere composto in base alle esigenze del cliente e fornito, su specifica richiesta, in sacchetti singoli oppure in un'unica confezione.
The kit can be made according to customer needs and provided, on request, in individual sachets or in a single package.

OTTONE - BRASS

MORSETTIERE SERIE A.D. ANTIDEFAGRANTI CLASSE TERMICA F (150 °C)

TERMINAL BLOCKS SERIES A.D. EXPLOSION-PROOF THERMAL CLASS F (150°C)

6 perni fissi a base cilindrica
6 fixed base cylindrical studs

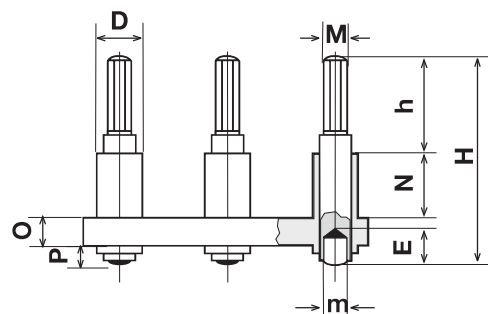
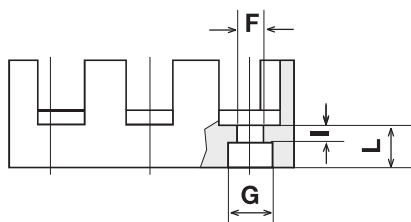
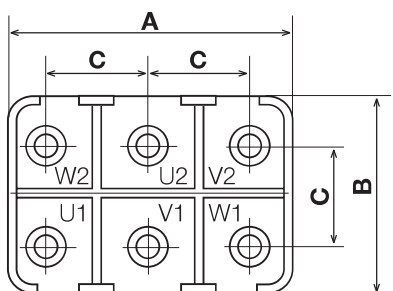
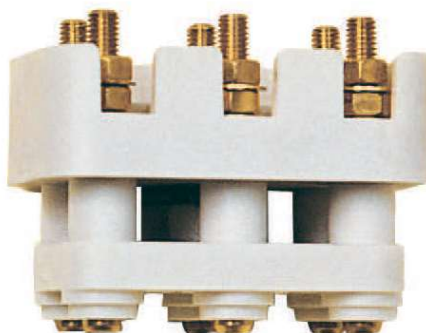
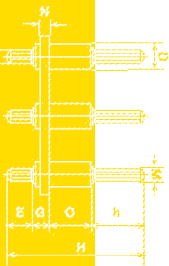

codice code	modello model	A	B	C	D	E	F	G	H	h	I	L	M	m	N	O	P
0173 MR	A.D. 77.49	77	49	25	15	7,7	9	15	66	30	5	12	M 6	6	21,2	6,8	6,2
0176 MR	A.D. 120.75	120	75	44	23	10,7	13,5	23,2	89	42	6,5	15,5	M 12	10	28	11,4	7,2

DOTAZIONE METALLICA STANDARD: 12 dadi, 3 piastrelle, 6 rondelle
METALLIC STANDARD EQUIPMENT: 12 nuts, 3 links, 6 washers

Il corredo può essere composto in base alle esigenze del cliente e fornito, su specifica richiesta, in sacchetti singoli oppure in un'unica confezione.
The kit can be made according to customer needs and provided, on request, in individual sachets or in a single package.

FI.A.M.E.

MORSETTIERE SERIE F.C. CERTIFICATE  US
CLASSE TERMICA F (150 °C)

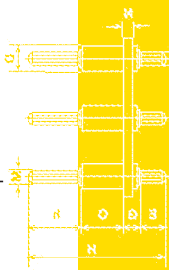

TERMINAL BLOCKS SERIES F.C. UL/CSA CERTIFIED THERMAL CLASS F (150°C)
6 perni fissi a base cilindrica in acciaio zincocromato
6 fixed base cylindrical studs in steel zinc plated chromate

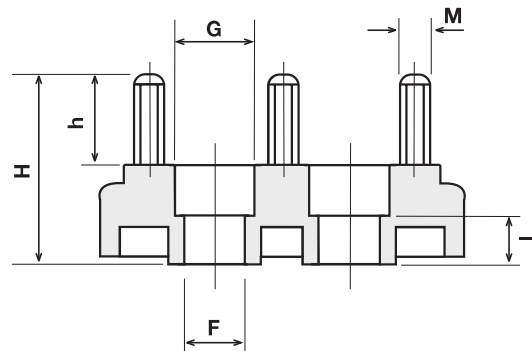
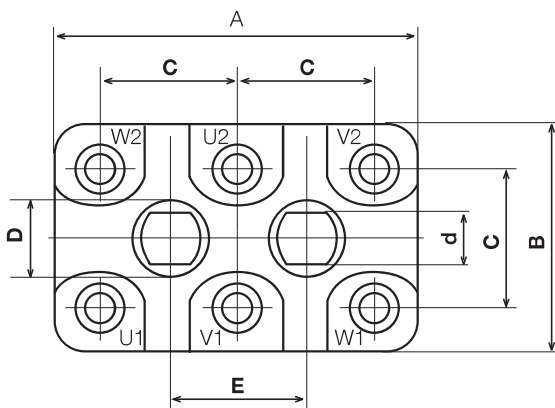

codice code	modello model	A	B	C	D	d	E	F	G	H	h	I	M
0151 MR	F.C. 40.25	40	25	15	9	4,8	15	7,2	9	22	12	5,5	M 4
0152 MR	F.C. 50.32	50	32	18	10,9	5,3	18	8,6	10,9	23	12	5	M 4
0153 MR	F.C. 56.36	56	36	20	11,9	6,2	20	9	11,9	26,5	15	5,5	M 5
0154 MR	F.C. 70.45	70	45	25	13,8	6,5	25	12	13,8	29	16	7,5	M 6
0156 MR	F.C. 82.52	82	52	30	14,1	6,6	30	10,8	14,1	32	16	12,5	M 6
0157 MR	F.C. 82.52	82	52	30	14,1	6,6	30	10,8	14,1	41	25	12,5	M 8
0155 MR	F.C. 95.60	95	60	35	15,8	8,2	35	10,6	19,6	46	25	14	M 8
0158 MR	F.C. 115.70	115	70	45	13,3	8,5	45	14,5	19,8	43	23	13	M8
0159 MR	F.C. 95.60	95	60	35	13	8	35	11,8	15	48	28	9	M10
0160 MR	F.C. 115.70	115	70	45	13,3	8,5	45	14,5	19,8	50	28	13,5	M10
0161 MR	F.C. 125.80	125	80	45	16,5	11	45	16	21	58	32	15	M12

DOTAZIONE METALLICA STANDARD: 12 dadi ZNC, 3 piastrine, 6 rondelle ZNC
 METALLIC STANDARD EQUIPMENT: 12 steel nuts, 3 links, 6 steel washers

Il corredo può essere composto in base alle esigenze del cliente e fornito, su specifica richiesta, in sacchetti singoli oppure in un'unica confezione.
 The kit can be made according to customer needs and provided, on request, in individual sachets or in a single package.

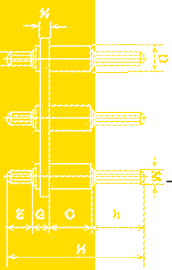

ACCIAIO ZINCOCROMATO - STEEL ZNC

**MORSETTIERE SERIE F.C. CERTIFICATE
CLASSE TERMICA F (150 °C)**



TERMINAL BLOCKS SERIES F.C. UL/CSA CERTIFIED THERMAL CLASS F (150°C)

**6 perni fissi a base cilindrica in acciaio zincocromato
6 fixed base cylindrical studs in steel zinc plated chromate**

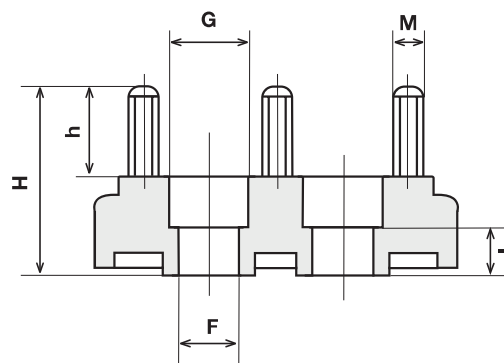
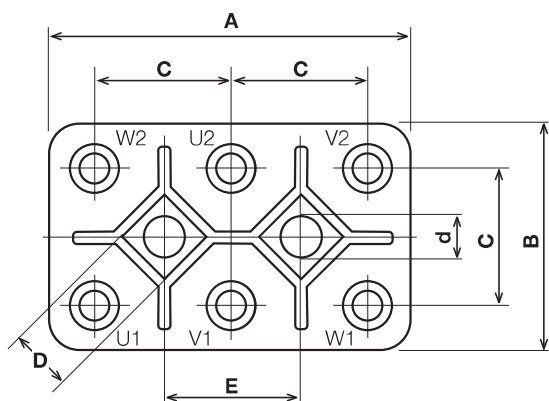

codice code	modello model	A	B	C	D	d	E	F	G	H	h	I	M
0131 ZNC	F.C. 54.34	54	34	20	10	6,2	20	6,2	14	25	12	6,5	M 4
0132 ZNC	F.C. 64.40	64	40	23	12	6,2	23	6,2	16	28	15	8	M 5

DOTAZIONE METALLICA STANDARD: 12 dadi ZNC, 3 piastrelle, 6 rondelle ZNC
METALLIC STANDARD EQUIPMENT: 12 steel nuts, 3 links, 6 steel washers

Il corredo può essere composto in base alle esigenze del cliente e fornito, su specifica richiesta, in sacchetti singoli oppure in un'unica confezione.
The kit can be made according to customer needs and provided, on request, in individual sachets or in a single package.

ACCIAIO ZINCOCROMATO - STEEL ZNC

MORSETTIERE SERIE F.C. CERTIFICATE CLASSE TERMICA F (150 °C)

TERMINAL BLOCKS SERIES F.C. UL/CSA CERTIFIED THERMAL CLASS F (150°C)

8 perni fissi a base cilindrica in acciaio zincocromato
8 fixed base cylindrical studs in steel zinc plated chromate

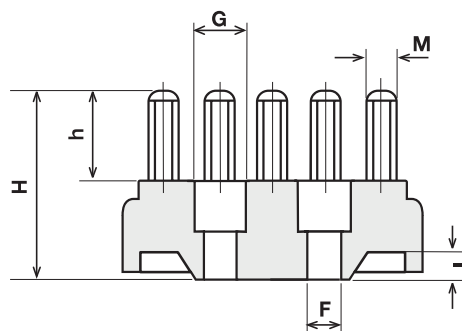
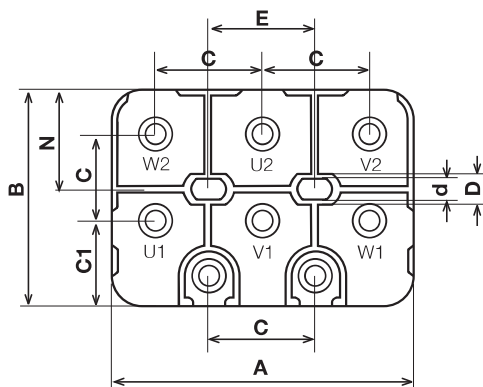
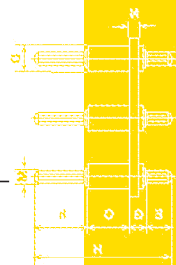

codice code	modello model	A	B	C	C1	D	d	E	F	G	H	h	I	M	N
0192 MR	F.C. 50.40	50	40	18	15	8	4,7	18	6,8	9,8	26	12	6	M 4	18

DOTAZIONE METALLICA STANDARD: 14 dadi ZNC, 3 piastrine, 8 rondelle ZNC
METALLIC STANDARD EQUIPMENT: 14 steel nuts, 3 links, 8 steel washers

Il corredo può essere composto in base alle esigenze del cliente e fornito, su specifica richiesta, in sacchetti singoli oppure in un'unica confezione.
The kit can be made according to customer needs and provided, on request, in individual sachets or in a single package.

NEW

MORSETTIERE NUOVO DESIGN CERTIFICATE

TERMINAL BLOCKS NEW DESIGN UL/CSA CERTIFIED

Con 6 perni fissi a base cilindrica in bakelite, classe termica F (colore nero, 150°C)
o poliestere, classe termica B (colore grigio chiaro, 130°C)
With 6 fixed base cylindrical studs in bakelite, thermal class F (150°C, black color)
or polyester, thermal class B (130°C, light grey color)

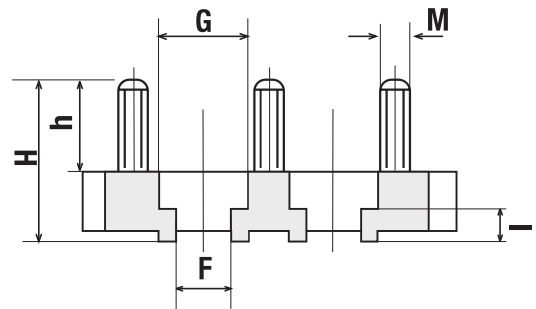
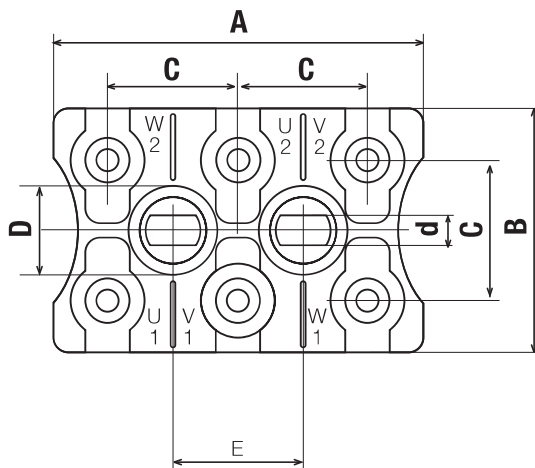

codice ottone brass code	codice znc zinc code	modello model	A	B	C	D	d	E	F	G	H	h	I	M
0114MR/POL	0150MR/POL	F.C. 44.27	44	27	15	8,3	5	15	5,8	8,3	21	12	5,5	M 4
0117MR/POL	0152MR/POL	F.C. 50.32	50	32	18	10	5,4	18	8,4	10	21	12	5,5	M 4
0118MR/POL	0153MR/POL	F.C. 56.36	56	36	20	12	6,2	20	9	12	26,5	15	7,7	M 5
0119MR/POL	0154MR/POL	F.C. 70.45	70	45	25	13,8	6,5	25	12	13,8	29	16	8,5	M 6

Morsettiere con design depositato, presso euipo (european union intellectual property office)
n. 004676575-001, N. 004676575-0002

Terminal blocks with registered design, by euipo (european union intellectual property office)
n. 004676575-001, N. 004676575-0002

DOTAZIONE METALLICA STANDARD: 12 dadi, 3 piastrine, 6 rondelle
METALLIC STANDARD EQUIPMENT: 12 nuts, 3 links, 6 washers

Il corredo può essere composto in base alle esigenze del cliente e fornito, su specifica richiesta, in sacchetti singoli oppure in un'unica confezione.
The kit can be made according to customer needs and provided, on request, in individual sachets or in a single package.

MORSETTIERE PREDISPOSTE CON SIGLATURA PER MOTORI ELETTRICI A DUE VELOCITÀ

PRESET INITIALED TERMINAL BLOCKS FOR TWO-SPEED ELECTRIC MOTORS

2 polarità - 1 avvolgimento - 1 tensione
2 polarities - 1 winding - 1 tension

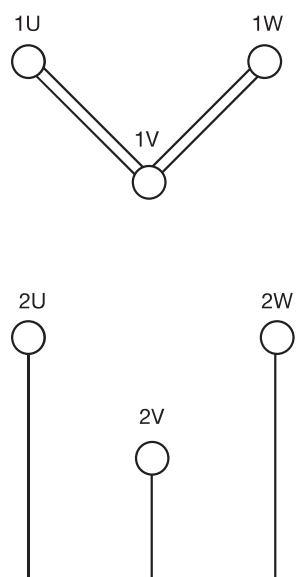
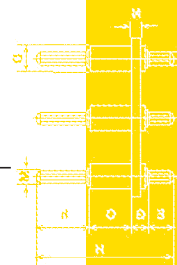

VELOCITÀ ALTA
HIGH - SPEED

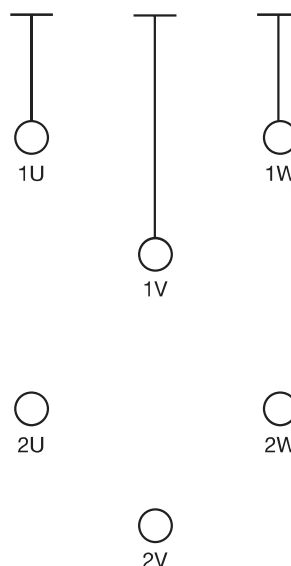

VELOCITÀ BASSA
LOW - SPEED

codice code	modello model	pagina page
0116-V2 F.C.	40-25 M4	1
0152-V2 F.C.	50-32 M4	2
0118-V2 F.Q.	56-36 M5	1
0119-V2 F.Q.	70-45 M6	1
0120-V2 F.C.	82-52 M6	1
0121-V2 F.C.	82-52 M8	1
0122-V2 F.C.	95-60 M8	1

codice code	modello model	pagina page
0124-V2 F.C.	95-60 M10	1
0125-V2 F.C.	115-70 M10	1
0126-V2 F.C.	125-80 M12	1
0127-V2 F.C.	145-90 M14	1
0128-V2 F.C.	165-100 M16	1
0129-V2 F.C.	240-150 M20	1
0122-V2 F.C.	95-60 M8	1

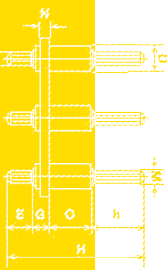

SPECIFICHE METALLURGIA

METALLURGY SPECIFICATIONS

DADI NUTS

OTTONE BRASS	ACCIAIO ZNCATO STEEL ZNC
M4	M4
M5	M5
M6	M6
M8	M8
M10	
M12	
M14	
M16	
M20	

RONDELLE WASHERS

OTTONE BRASS	ACCIAIO ZNCATO STEEL ZNC
M4x0,5	M4x0,5
M5x0,7	M5x0,7
M6x1	M6x1
M8x1	M8x1
M10x1	
M12x1	
M14x2,5	
M16x3	
M20x3	

RONDELLE GROWER GROWER WASHERS

MATERIALE MATERIAL	ACCIAIO ZINCATO / GREZZO STEEL ZNC / RAW
∅	4 ÷ 20

RONDELLE ZIGRINATE KNURLED WASHERS

MATERIALE MATERIAL	ACCIAIO ZINCATO / GREZZO STEEL ZNC / RAW
∅	4 ÷ 20

VITI AUTOMASCHIANTI SELF-FORMING SCREWS

MATERIALE MATERIAL	ACCIAIO ZINCATO / GREZZO STEEL ZNC / RAW
∅	4 - 5 - 6

PIASTRINE OTTONE LINKS BRASS

TIPO TYPE	MORSETTIERE TERMINAL BLOCKS
4x14/16	50.40 9p
4x15x0,5	40.25-40.40 9p
4x18x0,5	32.32 4p-38.30 4p-50.32-50.40 8p-50.50 9p-64.46 12p
4x20x0,5	54.34
5x16x0,5	62.45 9p
5x20x0,7	56.36-74.36 8p-52.52 9p-72.52 12p
5x23x0,5	64.40
5x23x1	64.46 F.Q.
6x25x1	70.45-65.65 9p-90.65 12p
6x30x1	82.52 M6
8x26-30x1	82.52 M8-134.50 9p
8x35x1	95.60 M8
10x35x1,5	95.60 M10
10x45x2	115.70
12x45x2	125.80
14x54x2,5	145.90
16x65x3	165.100
20x90x3	240.150





Morsetti da 4mmq
Transformer terminals 4mmq
disponibile 1, 2, 3 poli
available 1, 2, 3 poles

Morsetti da 4mmq, vite + faston
Transformer terminals 4mmq, screw + faston
disponibile 1, 2, 3 poli
available 1, 2, 3 poles



Morsetti da 10mmq
Transformer terminals 10mmq
disponibile 1, 2, 3 poli
available 1, 2, 3 poles



Morsetti portafusibile
disponibile per fusibili 5x20 - 5x25 - 6,3x32
Transformer-fused terminals
available for fused 5x20 - 5x25 - 6,3x32

Siglatra morsetti:
- numerose varianti con stampa standard
- versione neutra senza siglatra
- siglatra su specifica del cliente

Terminal initials:
- several variants with standard print
- neutral version without initials
- initials on specific request of customer